

Worksheet: Activity 1

Phishing examples

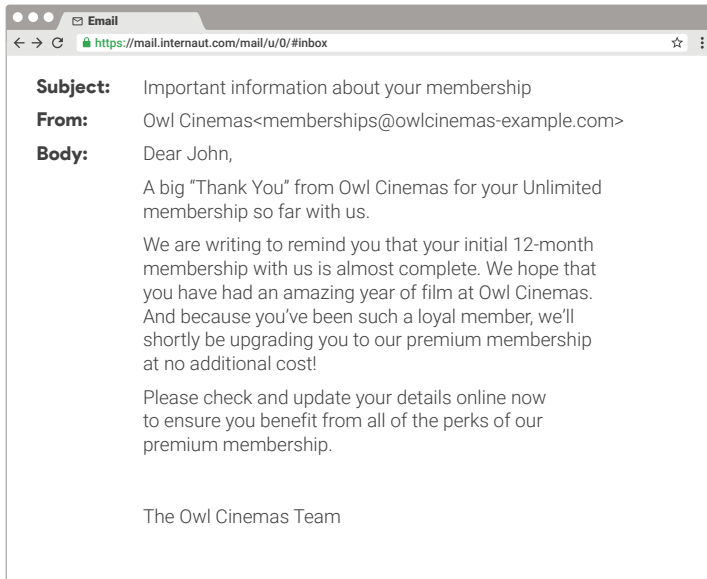

1. Is this real or fake?

Real

Fake

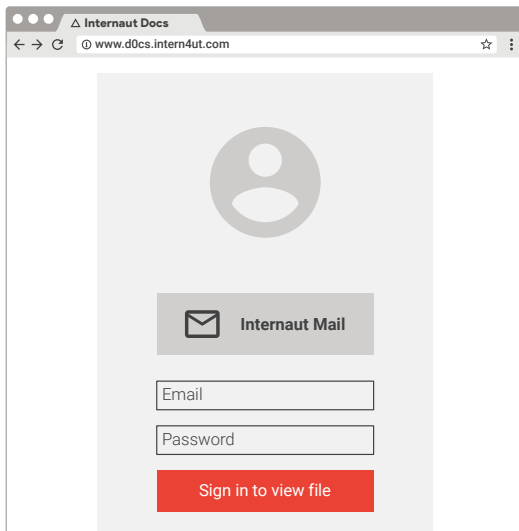

2. Is this real or fake?

Real

Fake

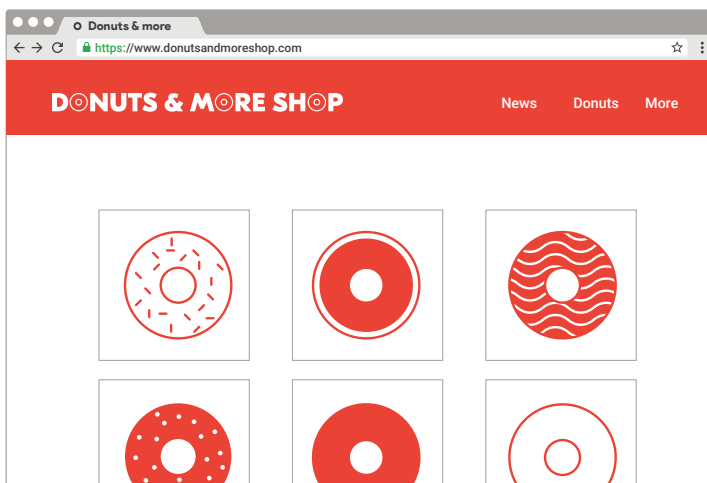

3. Is this real or fake?

Real

Fake

Continued on the next page →

Worksheet: Activity 1 (continued)

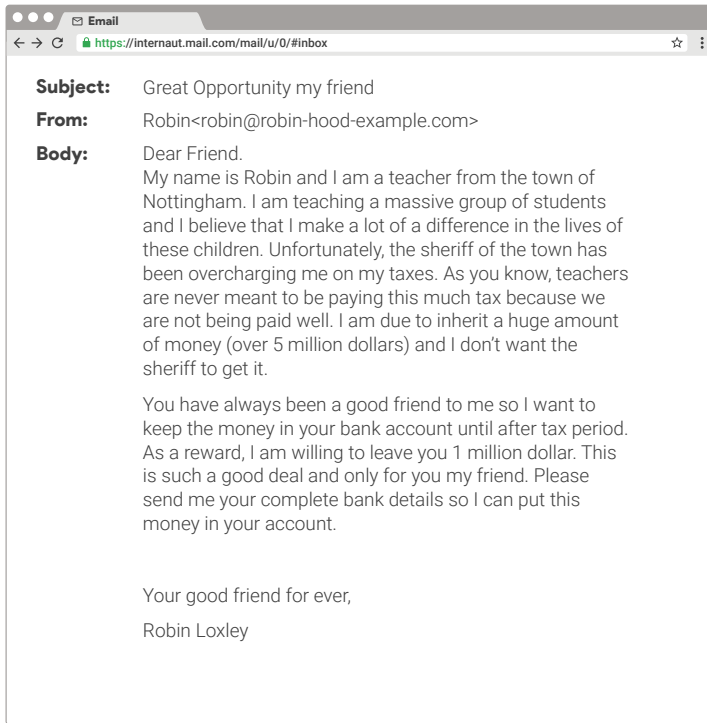

4. Is this real or fake?

Real

Fake

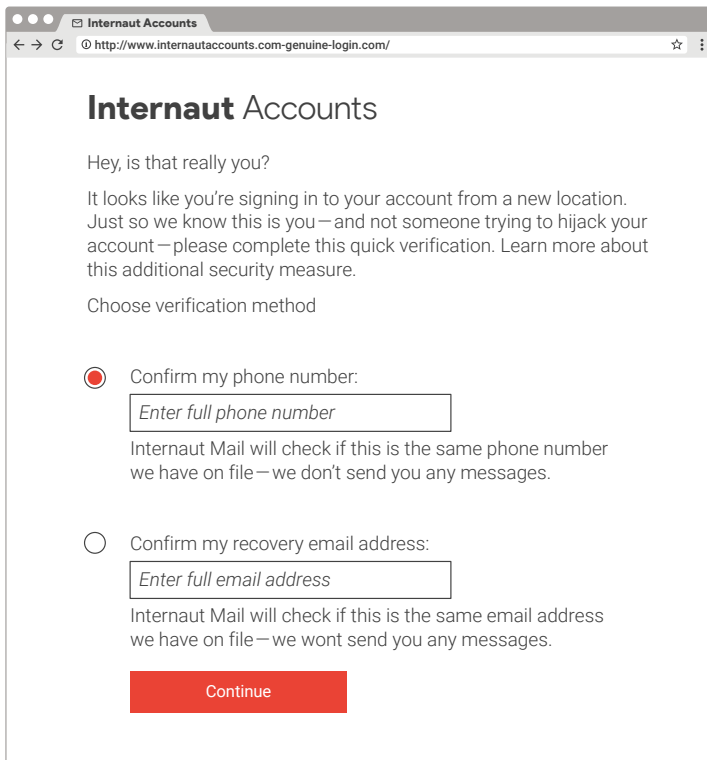

5. Is this real or fake?

Real

Fake